

TechnoFold-H & TechnoSlide

The High-End Folding and Sliding Shutters

By TechnoShade

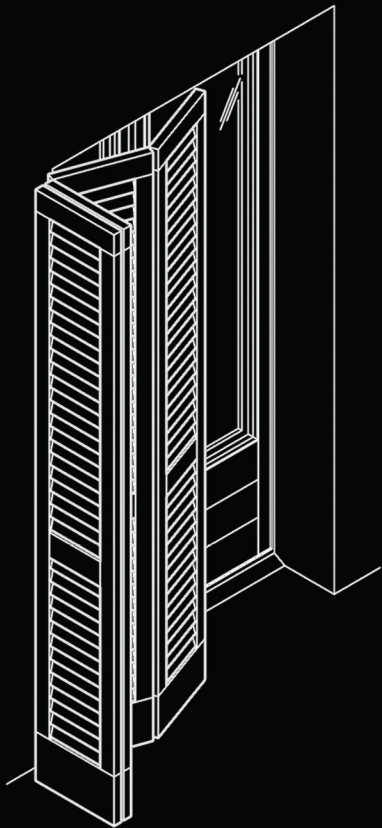

TechnoFold-H

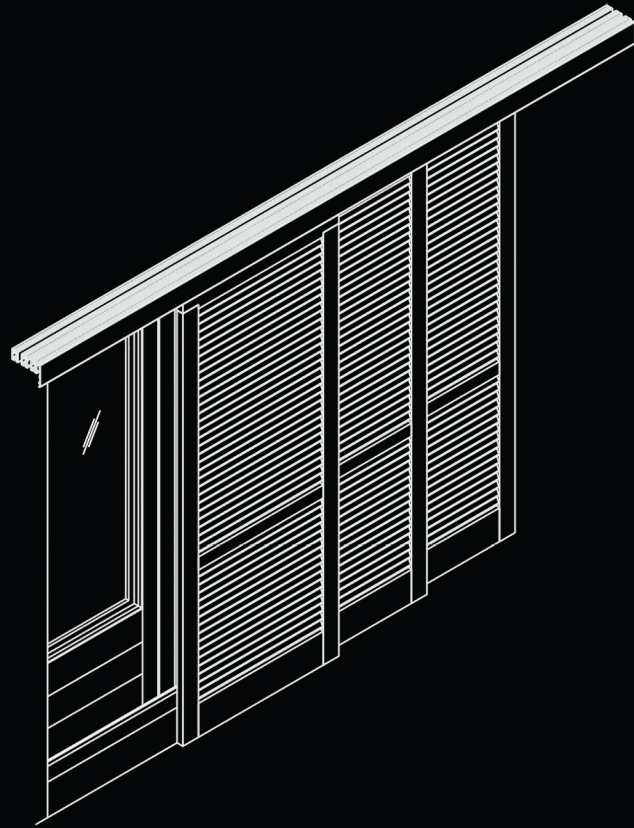

TechnoSlide

Being both an Architectural Element as well as a shading device, They are considered to be the High-End solution for External Window Treatment. The Folding and the Sliding shutters offer many advantages and features. They can be operated Manually or Automatically through a Motorization system.



Smart Window Solutions for Sustainable Architecture

TechnoFold-H

The High-End Horizontally Folding Shutter by TechnoShade

Description:

The TechnoShade-H is a shutter made of Wood, Aluminum or Steel, designed to be Manually or Electrically folded together and placed sideways, at an angle of 90 degree to the front of the window.

The TechnoFold-H is made of 4 main components:

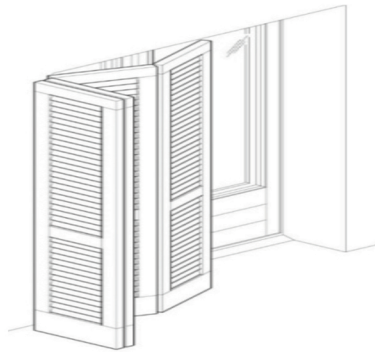

- 1) Hardware
- 2) Frame
- 3) Cladding
- 4) Motorization (optional)

1- Hardware:

This include all the Hinges and other high-end accessories especially designed for External Folding shutter. This Hardware system allows the Shutters to be folded together and placed sideways at an angle of 90 (degrees) to the front of the window.

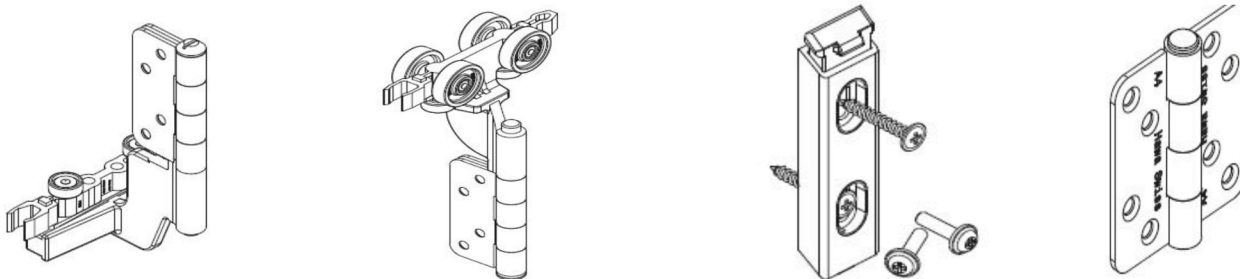

2- Frame:

Depending on the Architiect's choice, the frame could be made of Wood, Aluminum and even Steel. Each material having its own characteristics and strength, the size and design of the shutter will depend upon this choice.

3- Cladding:

The choice is wider regarding Cladding, as it could be made of Slats or sheets.

Slats: could be made of natural wood, High Pressure Laminate, Aluminum profiles and all in a variety of different shapes.

Sheets: could be plain, perforated or pattern computer cut, made of Aluminum, Stainless Steel, HPL or any other material suitable made for external use.

TechnoFold-H

The High-End Horizontally Folding Shutter by TechnoShade

4- Motorization:

In addition to standard manual operation, Motorization is available through a state-of-the-art system that can operate both light and heavy Shutters.

Standard Layout:

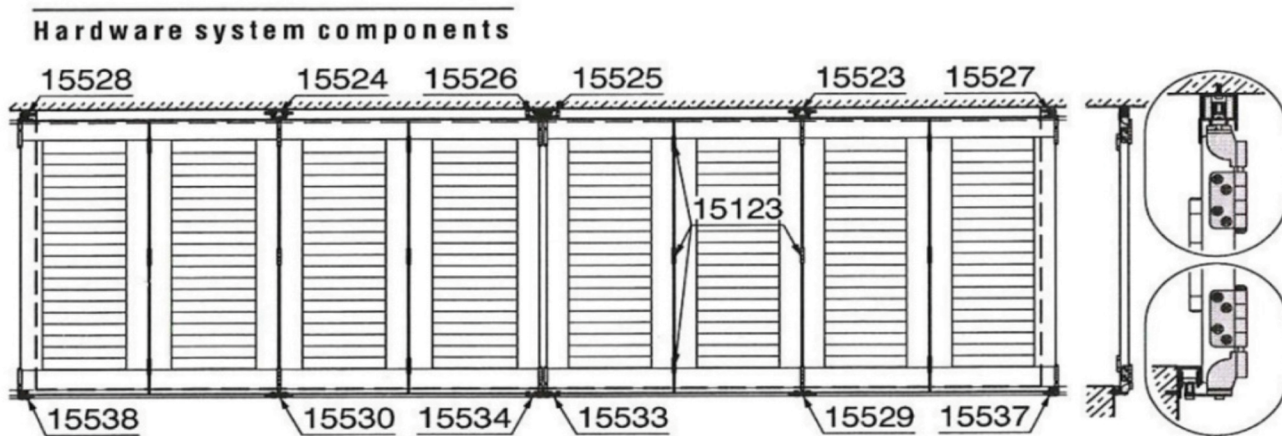

TechnoFold-H Shutters can be installed in front of the window or on the exterior of the balcony. The folding stack is installed on one side with pivot bearings

Mounting Possibilities:

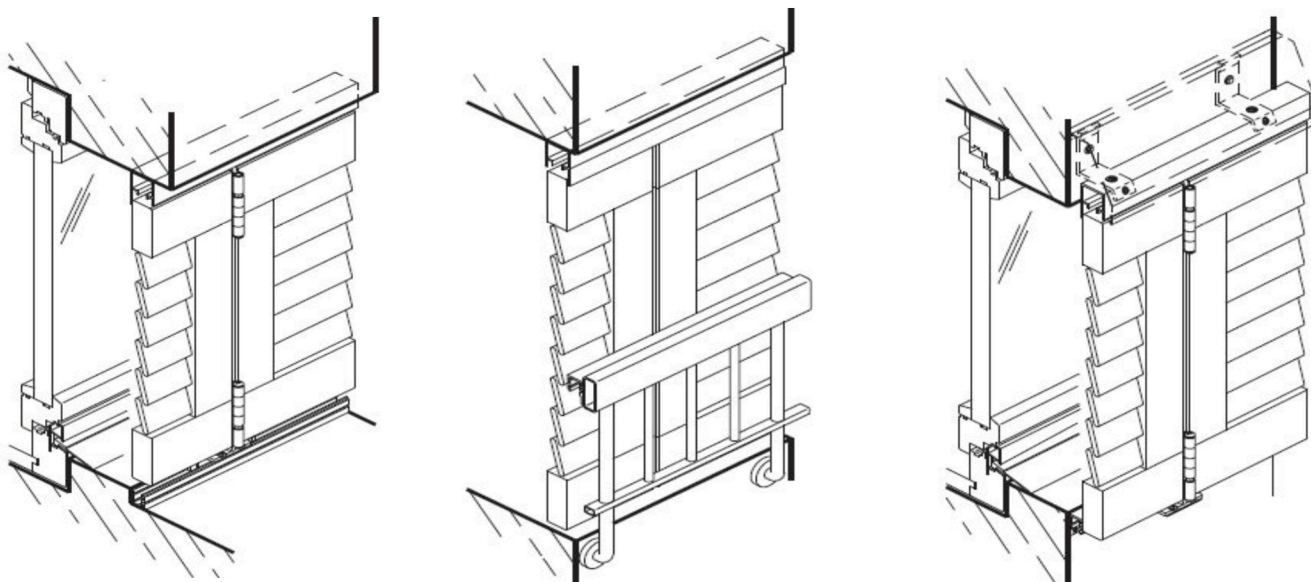

TechnoSlide

The High-End Sliding Shutter by TechnoShade

Description:

The TechnoSlide is a shutter made of Wood, Aluminum or Steel, designed to be Manually or Electrically slided, parallel to the front of the window.

The TechnoSlide is made of 4 main components:

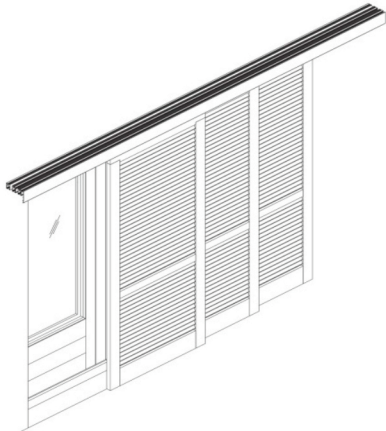

- 1) Hardware
- 2) Frame
- 3) Cladding
- 4) Motorization (optional)

1- Hardware:

This include all the Rollers and other high-end accessories especially designed for External Sliding shutter. This Hardware system allows the Shutters to be properly operated and placed, parallel to the front of the window.



2- Frame:

Depending on the Architect's choice, the frame could be made of Wood, Aluminum and even Steel. Each material having its own characteristics and strength, the size and design of the shutter will depend upon this choice.

3- Cladding:

The choice is wider regarding Cladding, as it could be made of Slats or sheets.

Slats: could be made of natural wood, High Pressure Laminate, Aluminum profiles and all in a variety of different shapes.

Sheets: could be plain, perforated or pattern computer cut, made of Aluminum, Stainless Steel, HPL or any other material suitable made for external use.

TechnoSlide

The High-End Sliding Shutter by TechnoShade

4- Motorization:

In addition to standard manual operation, Motorization is available through a state-of-the-art system that can operate both light and heavy Shutters.

Application:

Ideal for façades with a high proportion of glass, wherever screening and shade form part of the façade design, and where space is at a premium, e.g. schools, hotels, public buildings, office and administration premises, apartment buildings, low-energy houses, etc.

TechnoSlide Shutters can be installed in front of the window or on the exterior of the balcony.

Standard Sections:

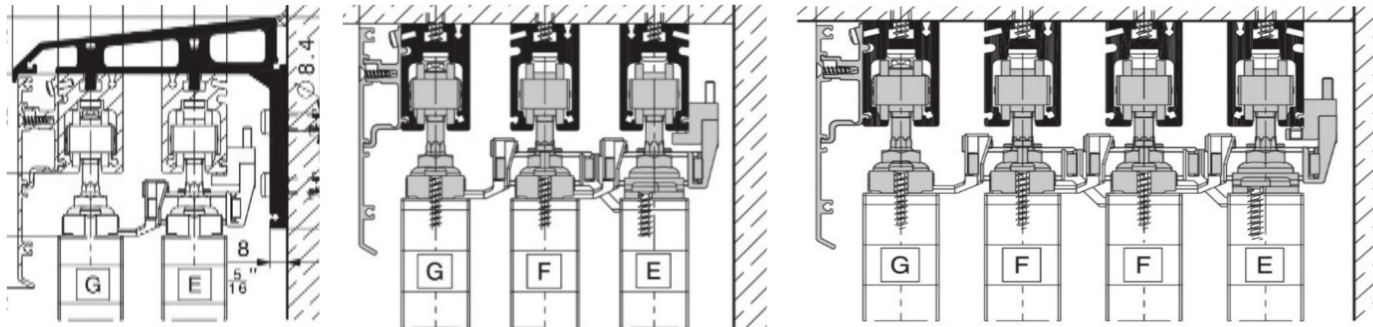

Standard Layout:

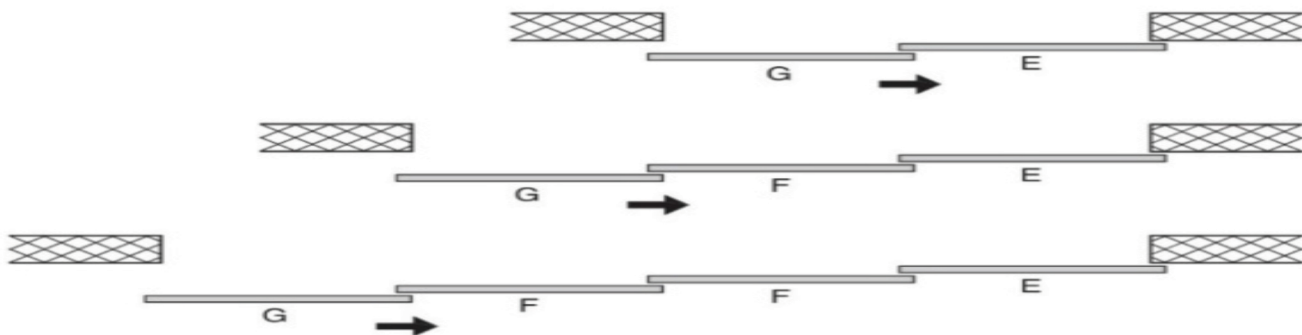

TechnoFold-H & TechnoSlide

The High-End Sliding Shutter by TechnoShade

Frame and Cladding:

A variety of shapes can be fabricated, according to the Architect's choice and to structure constraints.

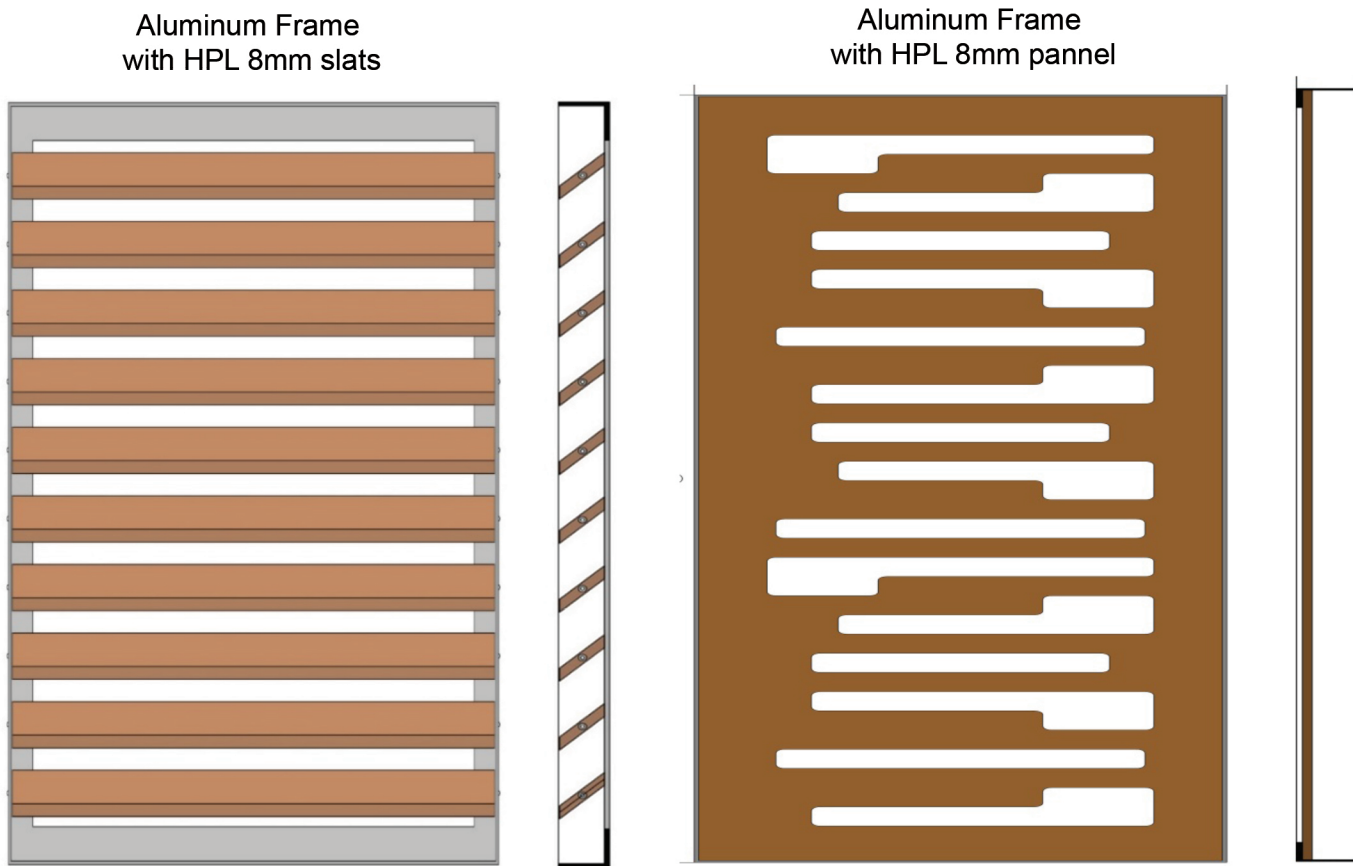

There are many possibilities to design a frame but the strength should also be taken into consideration. Each profile used has a different inertia and consequently is able to perform in different ways.

Examples of frame profiles:

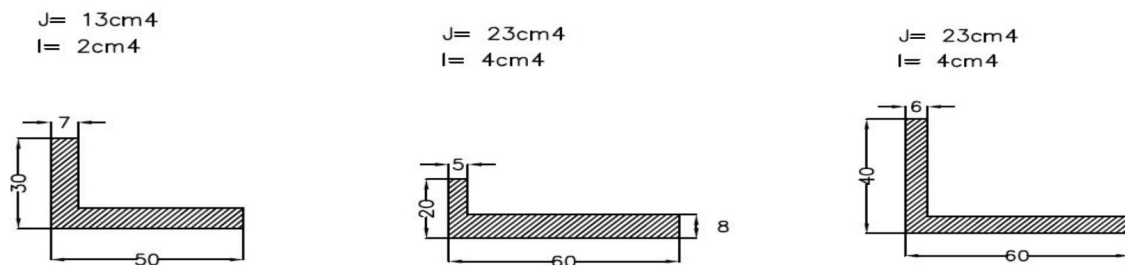

TechnoFold-H & TechnoSlide

Frame and Cladding:

A Variety of shapes can be fabricated, according to the Architect's choice and to structure constraints

**Stainless Steel Sheet
On Stainless Steel Frame**



**Vertical Wood Studs
On Steel Frame**



**Vertical Aluminum Profiles
On Aluminum Frame**



Standards and Classifications:

Resistance to Wind Load:

Relevant standards

EN 1932 (03/2001)

External blinds and shutters - Resistance to wind loads

Classification:

Class 6 (Resistance to wind loads)

Class 2 (Operating forces)

EN 13659 (06/2004) + A1 (10/2008) Shutters - Performance requirements including safety.

Anti-Corrosion:

All visible parts are inox, as they are made of Aluminum or Stainless Steel or even from reinforced plastic.

Anti-Vibration:

All the four components of the Shutter: Hardware, Frame, Cladding & Motor are designed to be anti-vibration and they consequently have a low noise level for a Smooth, Silent and Comfortable operation.



Through an overall approach to Sustainable Development, combining “bioclimatic principles” with both comfort to the occupant and refined Architecture, TechnoShade is a leading company involved in “Sustainable Architecture” through providing a variety of Smart Window Solutions. Our Automated Roller Shades, our Elegant Skylight Shades, our See-through Roller Shutters, our Smart & Motorized Louvers are all “energy-efficient” Architectural elements dedicated to form a “Dynamic Facade” and contribute in optimizing the energy performance of a building.

Our external Zipper Flyscreen offers to the tenants the possibility of ventilating their interior without having insects in. The Convertible Umbrellas and Pergolas Shadings are dedicated to provide additional living space and comfort.

TechnoShade has a 20-year experienced team following up all the different phases of making a smart building; from preliminary design to execution details followed by implementation and configuration.

TechnoShade has contributed in the realization of many projects in different applications such as residential towers, hospitals, administrative buildings, universities and hotels among them many are LEED certified.

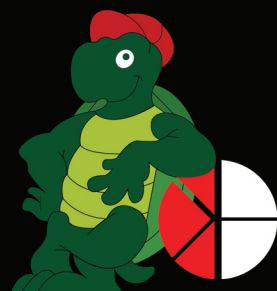

TechnoShade[®]
Natural Light Management™
www.technoshade.com